



SERVICE INSTRUCTION M20-117

Date: September 8, 2010

SUBJECT: TO ADVISE OWNERS OF CORRECT ORIENTATION MOUNTING THE NOSE GEAR "RETRACTING LINK" WHEN SERVICE AND MAINTENANCE IS PERFORMED ON ALL MOONEY AIRCRAFT.

**MODELS/ SN
AFFECTED:** All M20 thru M20TN Series Aircraft

**TIME OF
COMPLIANCE:** Time of Service and Maintenance

INTRODUCTION: There has been a reported instance in the field, that the nose gear "Retracting Link" was incorrectly installed (upside down). This incorrect installation caused the nose gear to collapse upon landing.

INSTRUCTIONS: This information is to clearly identify the correct orientation when installing the nose gear "Retracting Link" and orientation of the "over-center" tangent as shown in Figure 1.

Refer to the applicable Mooney Service Manual for nose gear rigging instructions.

WARRANTY: N/A

**REFERENCE
DATA:** Refer to Mooney Airplane Company Service Manuals (applicable A/C).

PARTS LIST: N/A

<u>Item</u>	<u>P/N</u>	<u>Description</u>	<u>QTY</u>
-------------	------------	--------------------	------------

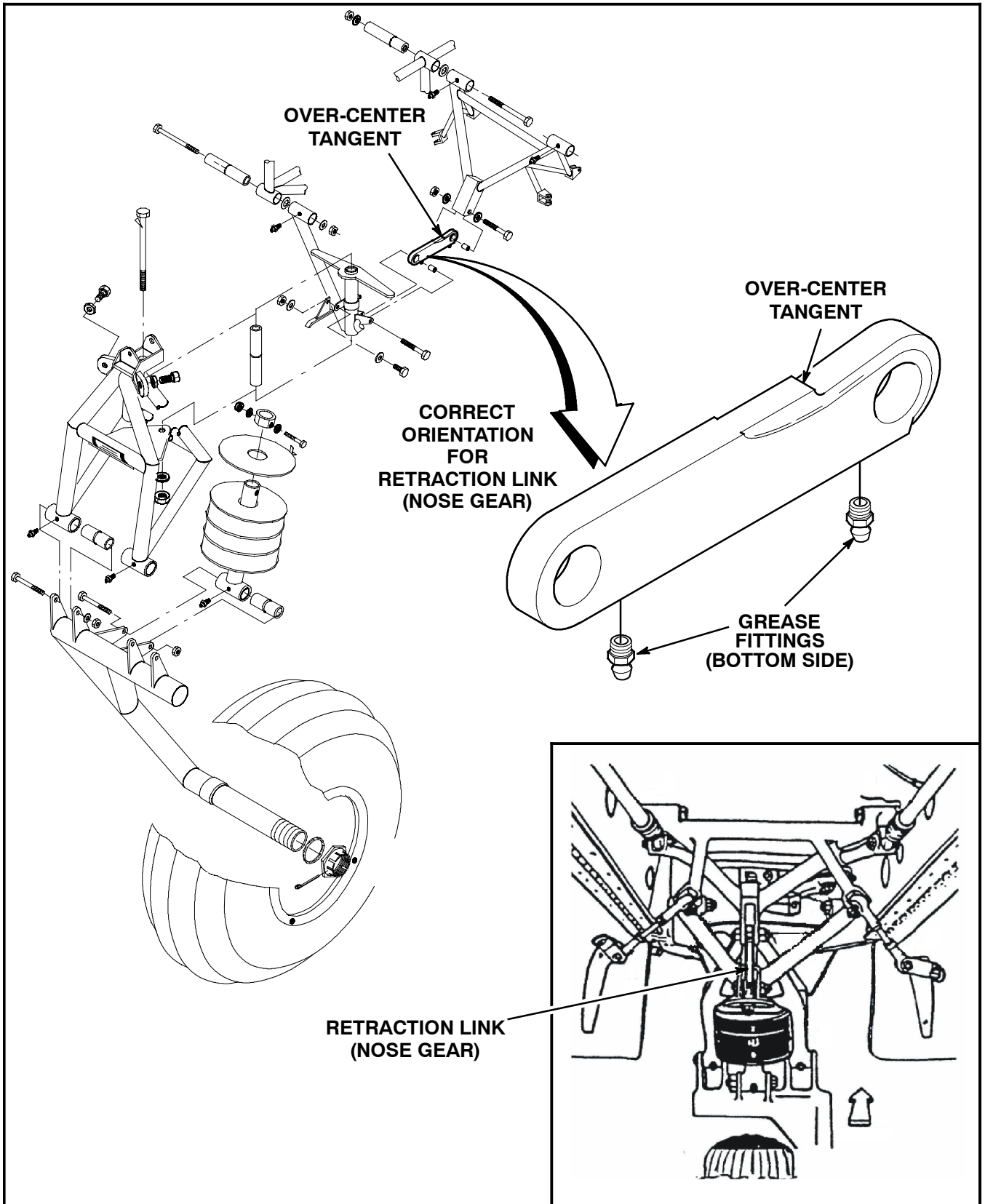

FIGURE 1 - ORIENTATION OF NOSE GEAR RETRACTION LINK